

Actual Images

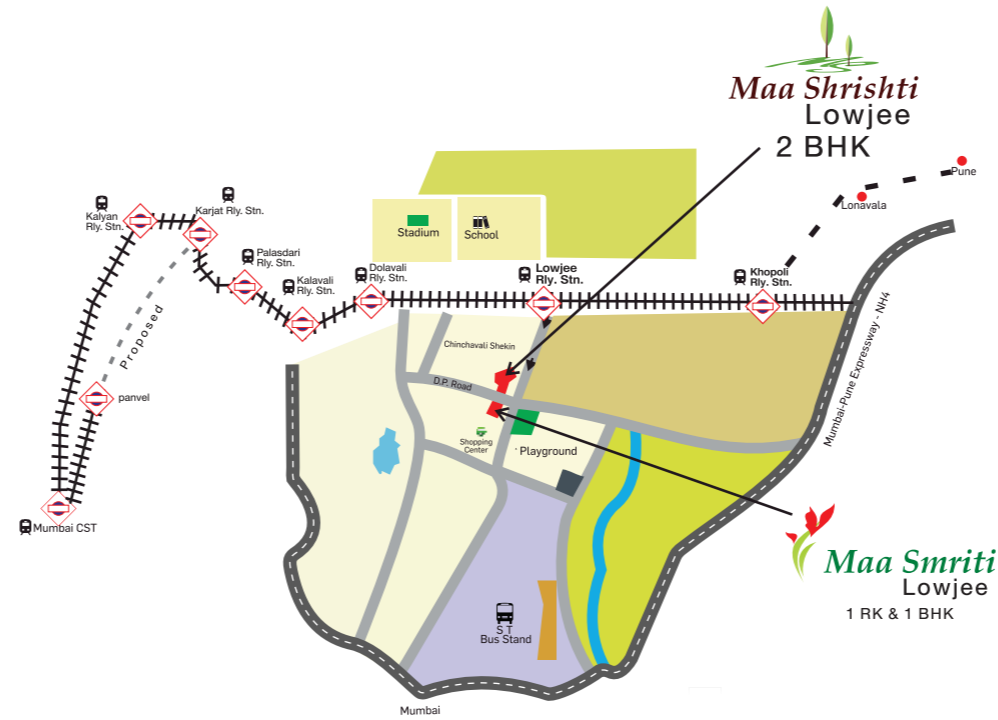

LOCATION MAP



Site Address:

C.T.S No.: 1106, Village- Chinchavali Shekin, Opp. Lowjee Railway Station, Khopoli, Tal. Khalapur, Dist. Raigad – 410203.

Architects:

Chaity Engineers and architect

R.C.C.:

C.S.E. Consultants

Legal Advisor:

Wadia Ghandy & Co.

A project by



Corporate Office: 28/29, Moraj Residency, Plot No. 1, Sector-16, Moraj Circle, Sanpada, Navi Mumbai-400 706.
Tel: 022 41410101/022 41110100 | Mob.: 9820577144
Email: sales@morajinftratech.com | newbiz@morajinftratech.com.



**AFFORDABLE
LIFE OFFERS
EXTRA HAPPINESS
THAT SUITS YOUR
BUDGET**



**Maa Shrishti
KHOPOLI**
2 BHK Available
MAHA RERA NO.
P52000000480

<https://maharera.mahaonline.gov.in>

**Maa Smriti
KHOPOLI**
1 RK & 1 BHK Available
MAHA RERA NO.
P52000005053



<https://maharera.mahaonline.gov.in>



ABOUT MORAJ

- It gives us immense pleasure to present our organization THE MORAJ GROUP and its organs.
- Moraj Infratech Pvt. Ltd. and Moraj Building Concepts Pvt. Ltd.
- Moraj a well known name in the real estate market at Navi- Mumbai had entered into the real estate business in a humble way during 1986.
- It has completed many prestigious projects which are constructed over 50 Lacs Sq.Ft.
- We, at Moraj, take pride in asserting that we don't create buildings, WE CREATE TRUST and it is the trust and business ethics that have made us a renowned name in the building industry.



PROJECT HIGHLIGHTS:

- Area: About 3 acres
- Units: 434 + Commercial Shops
- Buildings: 10
- Configuration: 1 RK, 1 BHK & 2 BHK
- Floors: Stilt + 7 with 2 Lifts in each building



FLAT SPECIFICATION:

- 2'x2' Vitrified Tiles
- Granite Top Kitchen
- 2ft high tiles above the kitchen platform
- 7ft high dado in bathroom and W.C.
- Copper Concealed wiring with circuit breaker switch
- Aluminum Sliding Windows with Glass
- Laminated Main Doors
- CP fittings in bathroom of reputed brand and many more....

PROJECT AMENITIES:

- Landscape Garden
- Community Hall
- Kids Play Area
- Stilt and Open Car Parking space

LOCATION ADVANTAGE:

Lowjee Station: Close proximity from Maa Smriti & Maa Shrishti, just 400 mtrs away

Khopoli Railway Station: 2 kms away from Maa Smriti & Maa Shrishti project

Karjat Railway Station is about 15 kms away from Maa Smriti & Maa Shrishti. The state transport bus depot is at a walking distance from the site.

Ashthavinayak Mahad Temple which is one of the eight (Ashta) Ganpati (Vinayak) temples of Maharashtra is situated a few kms away from the project. Vithoba temple is about 4-5 kms away. Very popular hill station for Mumbaikars - **Matheran** is about 38kms away, while Lonavla is 15 kms. Navi Mumbai is 58 kms and Alibaug about 62 kms away. The famous **Zenith Waterfall** and **Adlabs Imagica** is a few minutes' drive.

Maa Smriti & Maa Shrishti is also at a close proximity to the proposed shopping centre, school, playground and stadium of Khopoli Municipal Council.

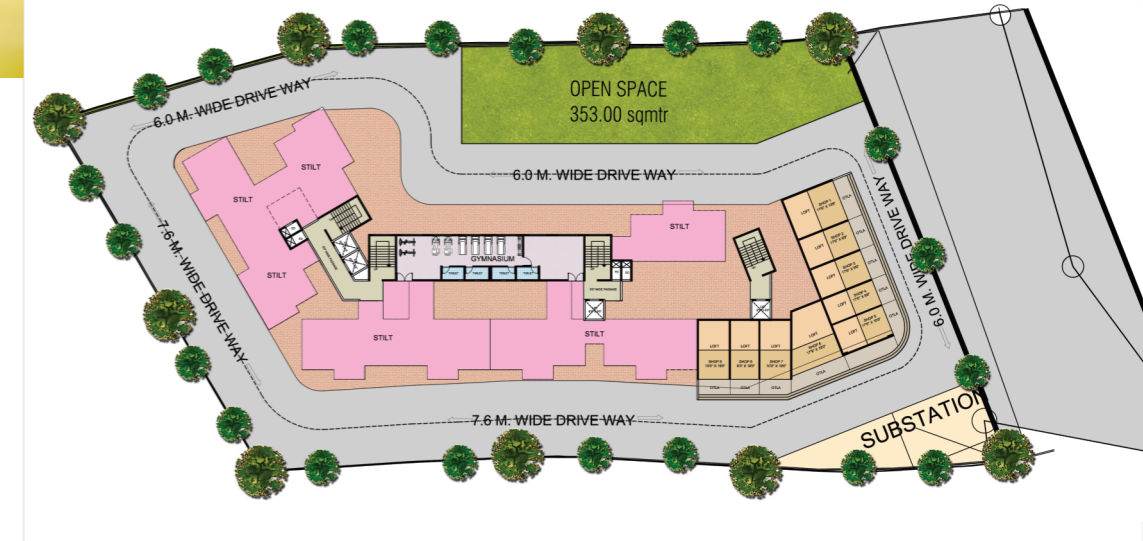

Maa Shrishti
Lowjee
2 BHK

Maa Smriti
Lowjee
1 RK & 1 BHK